



Computing Services Centre
香港城市大學
City University of Hong Kong

USER GUIDE FOR **USING AV EQUIPMENT**

Monterey Plaza

23/F Combined Meeting Room MPL-2311 & 2312

For IT or AV support, please contact the CSC Service Desk at **3442-8340**

AV Control Panel

Display Source Select

1. HDMI1 Input (Use HDMI devices) (Floor box 1, MPL-2311)
2. Wireless Presentation for Microsoft & Android /APPLE TV Device
3. Smart Board Built-in PC
4. Notebook / USB-C input (MPL-2311)
5. Notebook / USB-C input (MPL-2312)

Other Control

6. Speaker Volume Control
7. Mute Display
8. Lighting Control
9. VC Sounder Control
10. Mic Control
11. Smart Board in MPL-2311 (On/Off)
12. Smart Board in MPL-2312 (On/Off)
13. Projector in MPL-2311 (On/Off)
14. System Off
15. Help information

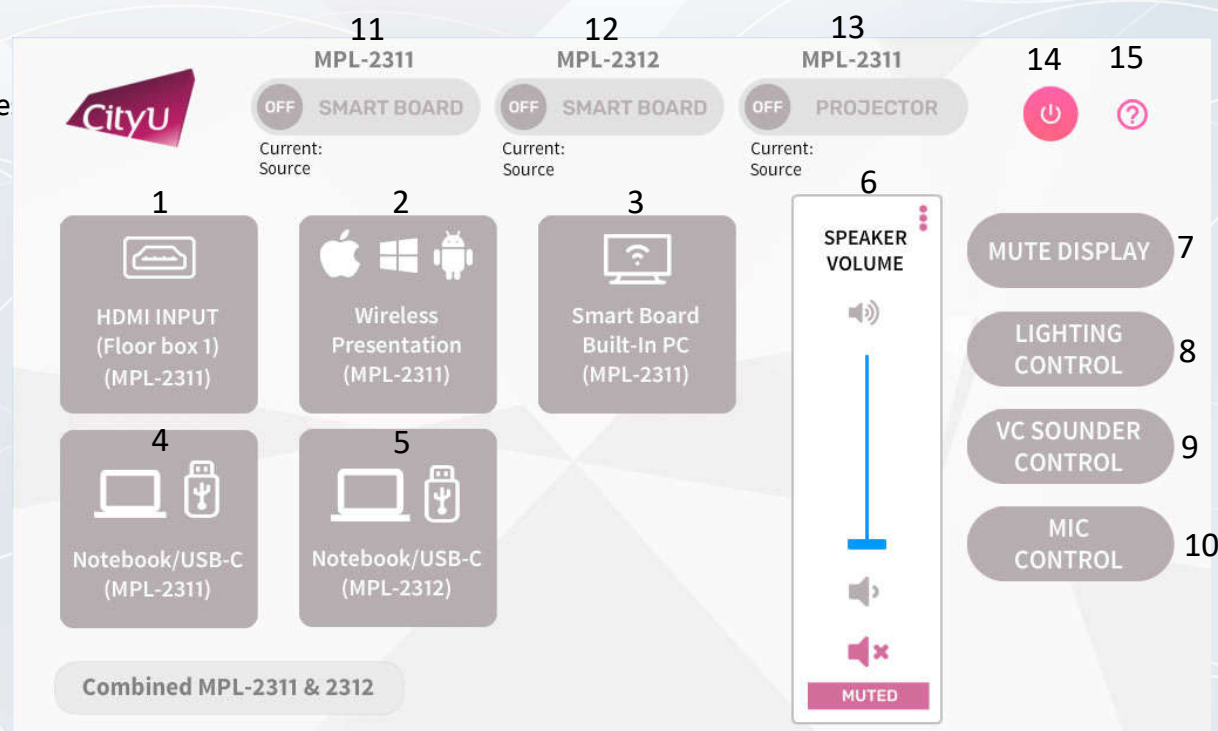

Using AV Equipment

Operation procedure of the HDMI Input

1. Press "HDMI INPUT (Floor box 1)(MPL-2311)" button
2. Connect the device to HDMI cable
3. Select Display Devices (Smart Board MPL-2311/ Projector MPL-2311/
Smart Board MPL-2312 / Projector MPL-2311 + Smartboard MPL 2312)

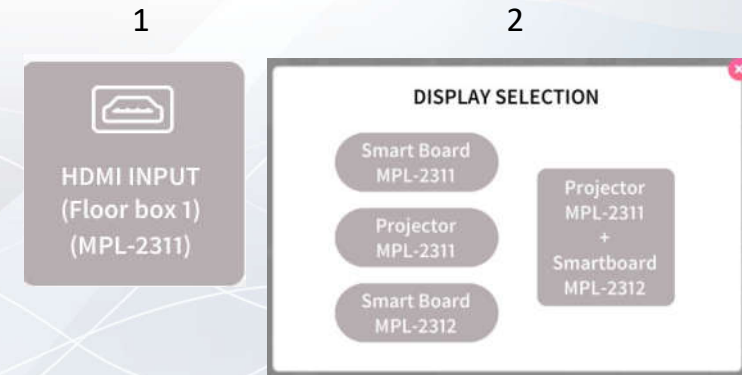

Operation procedure of wireless presentation for Microsoft & Android / Apple TV Device

1. Press "Wireless Presentation (MPL-2311)" button
2. Press "Microsoft/Android Devices(MPL-2311)" or "Apple Devices(MPL_2311)" button
3. Use Screen Mirroring to connect Microsoft & Android device or Apple Device
4. Select Display (Smart Board MPL-2311/ Projector MPL-2311/
Smart Board MPL-2312 / Projector MPL-2311 + Smartboard MPL 2312)

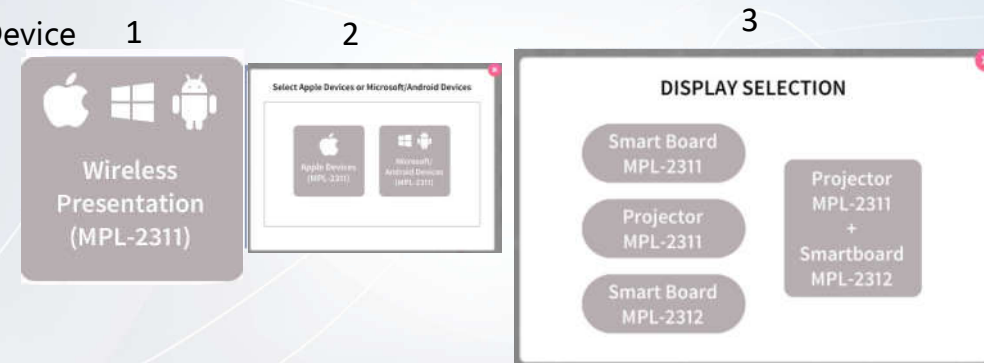

Using AV Equipment

Operation procedure of the Notebook / HDMI / USB-C Input at Room 2311

1. Press "Notebook / USB-C (MPL-2311)" button
2. Press "Notebook (MPL-2311)" or "HDMI (MPL-2311)" or "USB-C (MPL-2311)" button
3. Connect the device to HDMI cable at Room 2311
4. Select Display(s) (Smart Board MPL-2311/ Projector MPL-2311/ Smart Board MPL-2312 / Projector MPL-2311 + Smartboard MPL 2312)

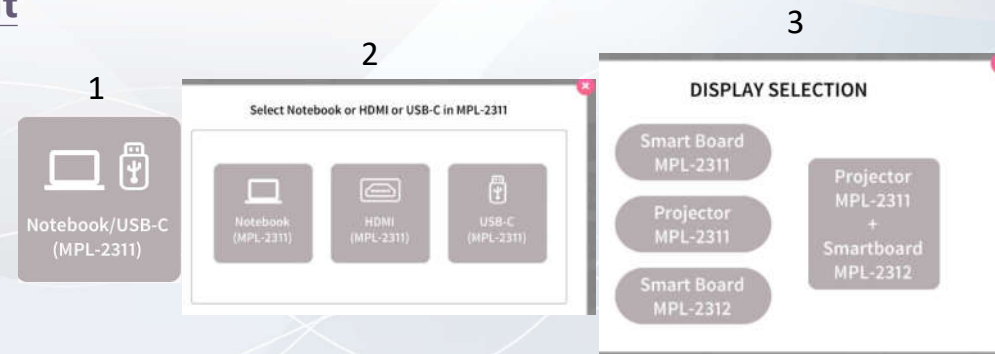

Operation procedure of the Notebook / HDMI / USB-C Input at Room 2312

1. Press "Notebook/USB-C (MPL-2312)" button
2. Press "Notebook (MPL-2312)" or "HDMI (MPL-2312)" or "USB-C (MPL-2312)" button
3. Connect the device to HDMI cable at Room 2312
4. Select Display(s) (Smart Board MPL-2311/ Projector MPL-2311/ Smart Board MPL-2312 / Projector MPL-2311 + Smartboard MPL 2312)

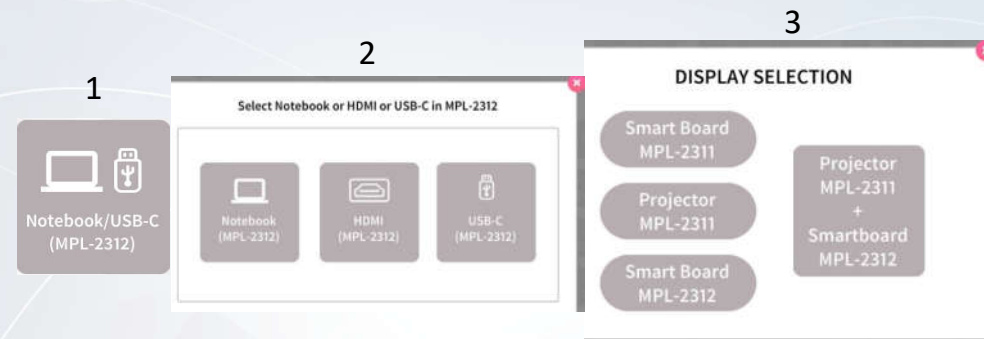

Operation of Lighting Control

1. MPL-2311 ALL ON
2. MPL-2311 ALL OFF
3. MPL-2311 Preset 1
4. MPL-2311 Preset 2
5. MPL-2311 Preset 3
6. MPL-2311 Preset 4

7. MPL-2312 ALL ON
8. MPL-2312 ALL OFF
9. MPL-2312 Preset 1
10. MPL-2312 Preset 2
11. MPL-2312 Preset 3
12. MPL-2312 Preset 4

13. CORRIDOR ALL ON
14. CORRIDOR ALL OFF
15. CORRIDOR Preset 1
16. CORRIDOR Preset 2
17. CORRIDOR Preset 3
18. CORRIDOR Preset 4

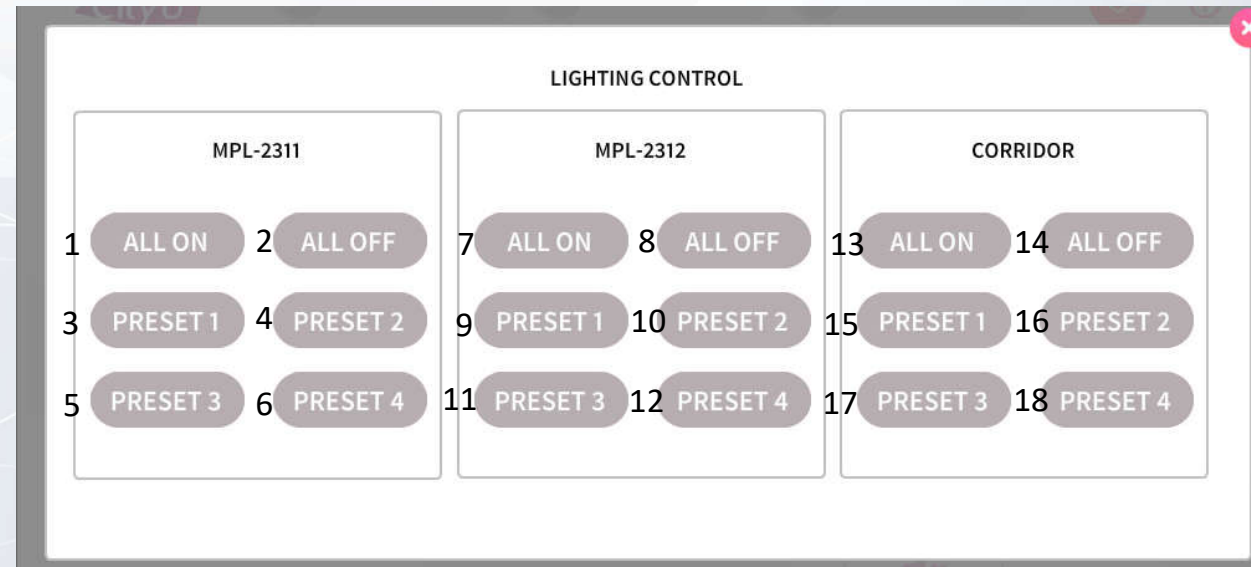

Using AV Equipment

Operation of MPL -2311 VC Soundbar

1. VC Soundbar On/Off
2. VC Volume Up
3. VC Volume down
4. Bluetooth
5. Mic Mute
6. Auto Framing
7. Connect to Smart Board
8. Connect to Notebook

Operation of MPL-2312 VC Soundbar

9. VC Soundbar On/Off
10. VC Volume Up
11. VC Volume down
12. Bluetooth
13. Mic Mute
14. Auto Framing
15. Connect to Smart Board
16. Connect to Notebook

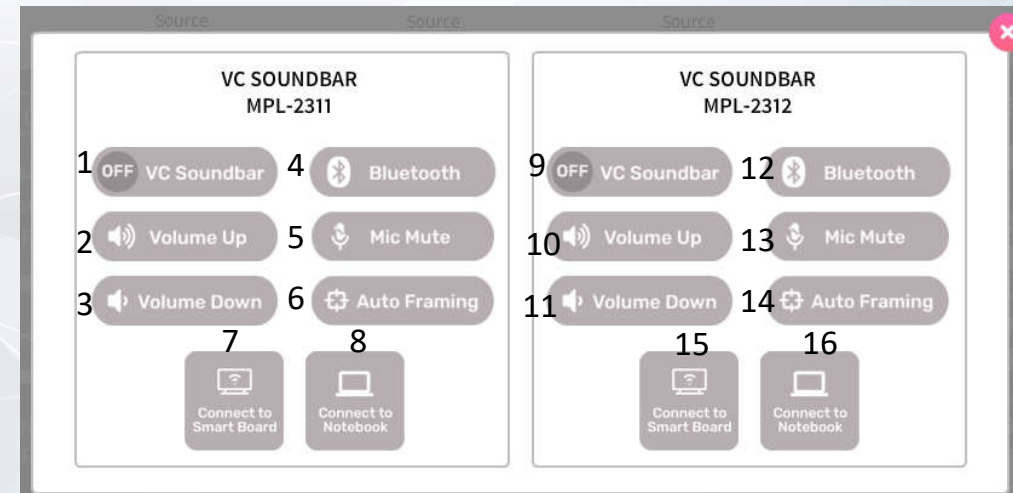

Operation of Wireless Mic Control

1. Handheld Mic 1 Mute
2. Handheld Mic 1 Volume down
3. Handheld Mic 1 Mute
4. Handheld Mic 2 Volume up
5. Handheld Mic 2 Volume down
6. Handheld Mic 2 Mute
7. Table Mic Volume up
8. Table Mic Volume Down
9. Table Mic Mute
10. Clip Mic Volume up
11. Clip Mic Volume down
12. Clip Mic Mute

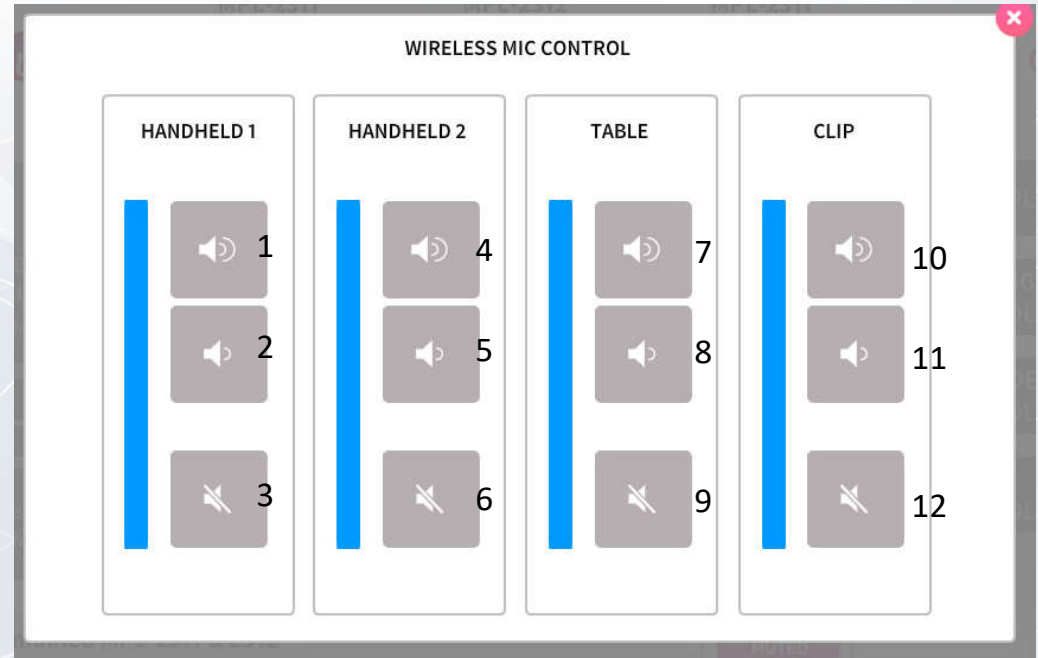

System OFF

1. Confirm Power off
2. Cancel Power off

